

# lichtmacher

TRACK 48V SYSTEM



ARKOSLIGHT®

LINE 1000

BLACK FOSTER MICRO 10

TOP

iO

FIT

PLUS

SIX

ZEN TUBE

SPIN

HOLLY

STICK 44

# Track 48V

TRIMLESS · SURFACE · SURFACE SHORT · SUSPENSION

LINE 48V

—  
500 / 1000 / 2000

10,5 / 21 / 42 W  
2700 / 3000 / 4000 K  
1500 / 6600 Lm  
98° BEAM  
43% LOR

BLACK FOSTER  
MICRO 48V

—  
5 / 10

7 / 14 W  
2700 / 3000 / 4000 K  
775 / 1700 Lm  
37° BEAM  
87% LOR

TOP 48V

—  
TOP MINI / TOP

6,5 W  
2700 / 3000 K  
610 / 640 Lm  
20 / 30 / 56° BEAM  
86 - 92 % LOR

iO 48V

4,5 W  
2700 / 3000 K  
485 / 505 Lm  
20 / 30 / 56° BEAM  
86 - 92 % LOR

FIT 48V

—  
20 / 35 / 50

2,1 - 12 W  
2700 / 3000 / 4000 K  
127 - 1230 Lm  
12 - 54° BEAM  
80 - 88 % LOR

PLUS 48V

—  
PLUS MINI / PLUS

6,5 / 18 W  
2700 / 3000 / 4000 K  
630 - 2030 Lm  
10 - 41° / 12 - 51° BEAM  
20 - 40 % LOR

SIX 48V

—  
XS / S / M / L

4,5 - 24,5 W  
2700 / 3000 / 4000 K  
470 - 3000 Lm  
17 - 38° BEAM  
84 - 93 % LOR

ZEN TUBE 48V

12 / 17 / 23 W  
2700 / 3000 K  
1580 - 3190 Lm  
16 / 24 / 42° BEAM  
90% LOR

SPIN 48V

6,5 W  
2700 / 3000 K  
600 / 630 Lm  
24 / 40° BEAM  
84 / 86 % LOR

HOLLY 48V

2,1 W  
2700 / 3000 K  
190 / 210 Lm  
19 / 38° BEAM  
90 / 92 % LOR

STICK 48V

—  
22 / 44 / 66

5,6 W  
2700 / 3000 K  
530 / 600 Lm  
22 / 37 / 46° BEAM  
81 - 84 % LOR

# TRACK 48V

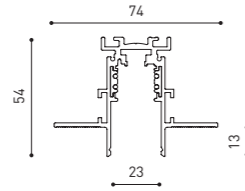
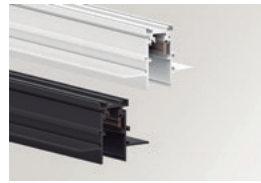

## TRACK 48V TRIMLESS

TRACK 48V TRIMLESS 1m	A338-01-00-   N   WT
TRACK 48V TRIMLESS 2m	A338-02-00-   N   WT
TRACK 48V TRIMLESS 3m	A338-03-00-   N   WT
TRACK 48V TRIMLESS Corner 90° One Plane	A338-06-00-   N   WT
TRACK 48V TRIMLESS Corner 90° Two Planes	A338-07-00-   N   WT

PLASTERBOARD CEILING, MANDATORY THICKNESS 12,5mm.  
RECOMMENDED FOR INSTALLATIONS WHERE THE PROFILE CAN BE  
INSTALLED BEFORE THE FALSE PLASTERBOARD CEILING.



### TRACK 48V TRIMLESS Corner 90° One Plane

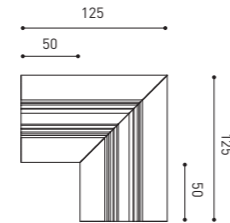

\*Electrical connection not included

### TRACK 48V TRIMLESS Corner 90° Two Planes

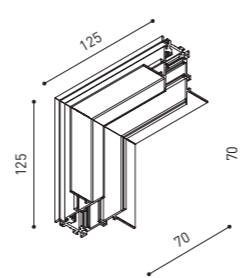

\*Electrical connection not included

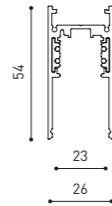

## TRACK 48V SURFACE

TRACK 48V SURFACE 1m	A338-11-00-   NT   WT
TRACK 48V SURFACE 2m	A338-12-00-   NT   WT
TRACK 48V SURFACE 3m	A338-13-00-   NT   WT
TRACK 48V SURFACE Corner 90° One Plane	A338-14-00-   NT   WT



### TRACK 48V SURFACE Corner 90° One Plane

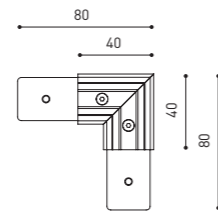

Electrical connection not included  
Straight joiner included

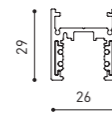

## TRACK 48V SURFACE SHORT

TRACK 48V SURFACE SHORT 1m	A338-21-00-   NT   WT
TRACK 48V SURFACE SHORT 2m	A338-22-00-   NT   WT
TRACK 48V SURFACE SHORT 3m	A338-23-00-   NT   WT
TRACK 48V SURFACE SHORT Corner 90° One Plane	A338-24-00-   NT   WT



### TRACK 48V SURFACE SHORT Corner 90° One Plane

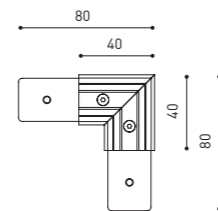

Electrical connection not included  
Straight joiner included

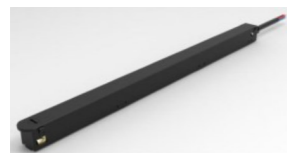

48V Driver in Schiene einbaubar  
100W48-w  
100W48-s

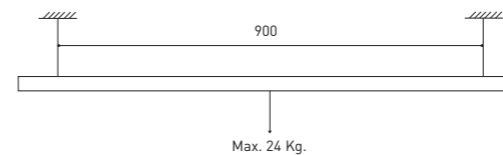
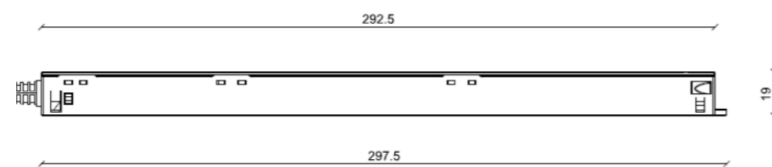

DROP VOLTAGE TABLE

POWER (W)	CABLE SECTION (mm <sup>2</sup> )	CABLE LENGTH (m)			
		5	10	20	30
150	0,75	40	15	X	X
	1,5	50	40	20	X

ACCESSORIES

# TRACK 48V

## ALL 48V TRACKS

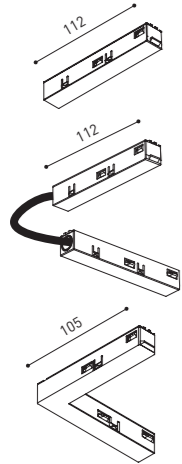

**TRACK 48V Live-End Connector**  
A338-00-01- | N | W |

**TRACK 48V Corner Connector**  
A338-00-12- | N | W |

**TRACK 48V Corner 90° Connector One Plane**  
A338-00-24- | N | W |

\*Not suitable for trimless version

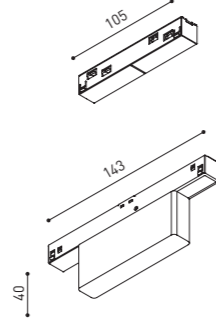

**TRACK 48V Central Connector**  
A338-00-02- | N | W |

**TRACK 48V Wireless Control**  
0434-01-31- | N | W | Casambi/AAG Stucchi App

## TRIMLESS 48V

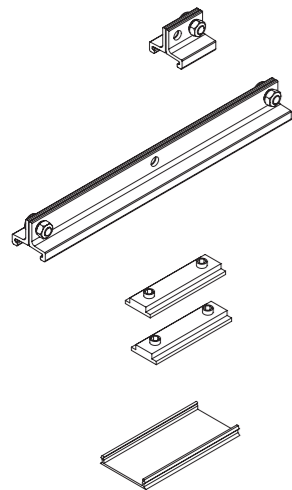

**TRACK 48V TRIMLESS Short T-Bracket**  
A338-00-03

**TRACK 48V TRIMLESS Long T-Bracket**  
A338-00-04

**TRACK 48V TRIMLESS Straight Joiners (2 units)**  
A338-00-05- | N | WT |

**TRACK 48V TRIMLESS Plaster Installation Guard 1m**  
A338-00-21

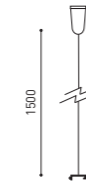

**TRACK 48V TRIMLESS Suspension Kit**  
A338-00-08

\*See accessories quantities

**\* SUGGESTED MOUNTING ACCESSORIES QUANTITIES**  
1000mm - 2 Pcs.  
2000mm - 2 Pcs.  
3000mm - 3 Pcs.

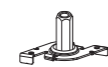

**TRACK 48V TRIMLESS Clamp for M6 ROD**  
A338-00-09

\*See accessories quantities



**TRACK 48V TRIMLESS Track Clamp**  
A338-00-10

\*See accessories quantities

## SURFACE, SUSPENSION, SURFACE SHORT & SUSPENSION SHORT 48V

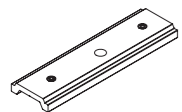

**TRACK 48V SURFACE Straight Joiner**  
A338-00-11

COLOUR | N ■ | W □ | NT ■ | WT □ |

RAL ⓘ » 538

ACCESSORIES

# TRACK 48V

## SUSPENSION & SUSPENSION SHORT 48V

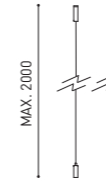

**TRACK 48V SURFACE Suspension Kit (2 units)**  
A338-00-15- | NT | WT |

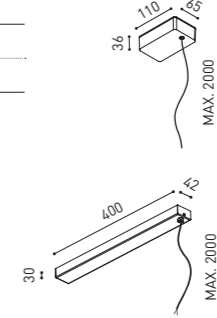

**TRACK 48V SURFACE Suspension Feed Kit**  
A338-00-16- | N | W | NO DIM  
A338-00-17- | N | W | DIM  
\*For remote power supply

**TRACK 48V Wired Power Supply Case**  
A338-00-25- | NT | WT | 150W NO DIM  
A338-00-26- | NT | WT | 150W DIM  
220 V~  
240 V~  
INCL

## SURFACE & SURFACE SHORT 48V

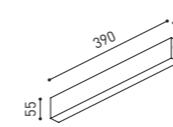

**TRACK 48V Power Supply Case**  
A338-00-29- | NT | WT | 150W

220 V~  
240 V~  
INCL \*To be installed aside 48V Surface Tracks

## WIRE TRIMLESS ACCESSORIES

### FEED

#### Mains Trimless\*

A023-00-01- | W | N | NO DIM

#### Mains Thick Trimless\*

A023-00-02- | W | N | DIM



### MAINS TRIMLESS

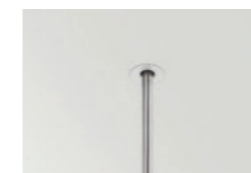

### MAINS THICK TRIMLESS

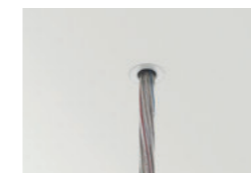

### STEEL CABLE TRIMLESS

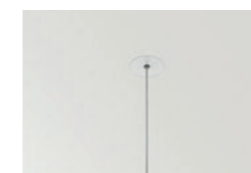

### FASTENING

#### Steel Cable Trimless\*

A023-00-05- | W | N |



COLOUR | N ■ | W □ | NT ■ | WT □ |

\* AS MANY PIECES AS NEEDED ACCORDING TO YOUR PRODUCT

RAL ⓘ » 538

## TRIMLESS, SURFACE & SUSPENSION 48V



**TRACK 48V TRIMLESS & SURFACE End**  
A338-00-06- | NT | WT |

**TRACK 48V TRIMLESS & SURFACE End Feed**  
A338-00-07- | NT | WT |

## SURFACE SHORT & SUSPENSION SHORT 48V



**TRACK 48V SURFACE SHORT End**  
A338-00-18- | NT | WT |

**TRACK 48V SURFACE SHORT End Feed**  
A338-00-19- | NT | WT |



# Wiz 48V

TRACK 48V



>> MORE INFO

WIZ 48V	+RE	P	CCT	I	Flux	LOR
A465-0- ∅ -10-   WT   NT   WTW   NTW   -S		12,4W	2700K	350mA	1470 lm	86%
A465-0- ∅ -11-   WT   NT   WTW   NTW   -S		12,4W	3000K	350mA	1530 lm	86%
A465-0- ∅ -12-   WT   NT   WTW   NTW   -S		12,4W	4000K	350mA	1550 lm	86%

48 V | IP20 | CRI>90 |  $L_{80B10} > 60,000$  h



∅	*OPTIONS
1	No DIM
2	DIM DALI

+RE	REF. ENDING	EXAMPLE
∅	Track 48V	A4650110WT
-S	Track 48V Short	A4650110WT-S

OPTIONAL  
**WIZ High Chromatic LED**  
 NOT SOLD SEPARATELY  
 AFFECTS THE LIGHTING PARAMETERS

FINISHING	Body	Lampshade	Adaptor
WT	WT <input type="checkbox"/>	N <input checked="" type="checkbox"/>	N <input checked="" type="checkbox"/>
NT	NT <input checked="" type="checkbox"/>	N <input checked="" type="checkbox"/>	N <input checked="" type="checkbox"/>
WTW	WT <input type="checkbox"/>	N <input checked="" type="checkbox"/>	W <input type="checkbox"/>
NTW	NT <input checked="" type="checkbox"/>	N <input checked="" type="checkbox"/>	W <input type="checkbox"/>

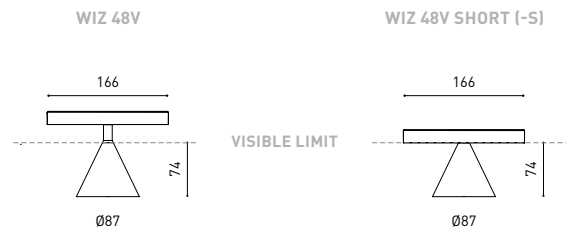

COLOUR | WT  | NT  | W  | N  | MATERIAL | AL | ABS+PC |

\* OTHER DIM OPTIONS PLEASE CONSULT

+RE >> THE PRODUCTS FOR THE TRACK 48V SHORT, ADD "-S" AT THE END OF THE SALES REFERENCE (AFTER THE LETTERS WHICH INDICATE THE COLOUR OF THE PRODUCT).

» PLEASE CONSULT



Private residence | Aurea arquitectos | Photography: Cuatli Photo Studio

## 48V SYSTEM SIX 48V



>> MORE INFO

SIX L 48V	+RE	P	CCT	Beam	I	Flux	LOR
A329-0- Ⓞ -10-   WT   NT   WTW   NTW   -S		24,5W	2700K	17°	700mA	2850 lm	93%
A329-0- Ⓞ -11-   WT   NT   WTW   NTW   -S		24,5W	3000K	17°	700mA	2950 lm	93%
A329-0- Ⓞ -12-   WT   NT   WTW   NTW   -S		24,5W	4000K	17°	700mA	3000 lm	93%
A329-0- Ⓞ -30-   WT   NT   WTW   NTW   -S		24,5W	2700K	26°	700mA	2850 lm	93%
A329-0- Ⓞ -31-   WT   NT   WTW   NTW   -S		24,5W	3000K	26°	700mA	2950 lm	93%
A329-0- Ⓞ -32-   WT   NT   WTW   NTW   -S		24,5W	4000K	26°	700mA	3000 lm	93%
A329-0- Ⓞ -20-   WT   NT   WTW   NTW   -S		24,5W	2700K	34°	700mA	2850 lm	90%
A329-0- Ⓞ -21-   WT   NT   WTW   NTW   -S		24,5W	3000K	34°	700mA	2950 lm	90%
A329-0- Ⓞ -22-   WT   NT   WTW   NTW   -S		24,5W	4000K	34°	700mA	3000 lm	90%

48 V | III | IP20 | CRI>90 | L80B10 >60.000h



### Ⓞ \*OPTIONS

1	No DIM
2	DIM DALI

### +RE REF. ENDING EXAMPLE

Ⓞ	Track 48V	A3290110WT
-S	Track 48V Short	A3290110WT-S

### OPTIONAL

SIX L High Chromatic LED ⓘ » 536

NOT SOLD SEPARATELY  
AFFECTS THE LIGHTING PARAMETERS

### FINISHING Lamp Adaptor

WT	WT □	N ■
NT	NT ■	N ■
WTW	WT □	W □
NTW	NT ■	W □



COLOUR | WT □ | NT ■ | W □ | N ■ |

MATERIAL | AL | PC |

RAL ⓘ » 538

+RE >> THE PRODUCTS FOR THE TRACK 48V SHORT, ADD "-S" AT THE END OF THE SALES REFERENCE (AFTER THE LETTERS WHICH INDICATE THE COLOUR OF THE PRODUCT).

Ⓞ ⓘ » PLEASE CONSULT



>> MORE INFO

SIX M 48V	+RE	P	CCT	Beam	I	Flux	LOR
A330-0- ① -10-   WT   NT   WTW   NTW   -S		17W	2700K	19°	500mA	2050 lm	93%
A330-0- ① -11-   WT   NT   WTW   NTW   -S		17W	3000K	19°	500mA	2130 lm	93%
A330-0- ① -12-   WT   NT   WTW   NTW   -S		17W	4000K	19°	500mA	2160 lm	93%
A330-0- ① -20-   WT   NT   WTW   NTW   -S		17W	2700K	28°	500mA	2050 lm	91%
A330-0- ① -21-   WT   NT   WTW   NTW   -S		17W	3000K	28°	500mA	2130 lm	91%
A330-0- ① -22-   WT   NT   WTW   NTW   -S		17W	4000K	28°	500mA	2160 lm	91%
A330-0- ① -30-   WT   NT   WTW   NTW   -S		17W	2700K	38°	500mA	2050 lm	93%
A330-0- ① -31-   WT   NT   WTW   NTW   -S		17W	3000K	38°	500mA	2130 lm	93%
A330-0- ① -32-   WT   NT   WTW   NTW   -S		17W	4000K	38°	500mA	2160 lm	93%

48 V | IP20 | CRI>90 | L80B10 >60.000h

MacAdam Step 2 | OPTIONS\* | INCL | TRACK 48V | 360° | 310° | 19° / 28° / 38°

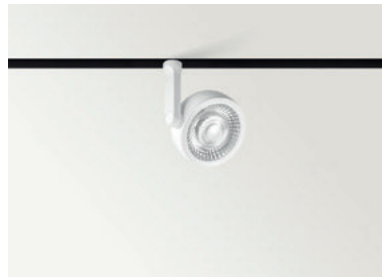

>> MORE INFO

SIX S 48V	+RE	P	CCT	Beam	I	Flux	LOR
A333-0- ① -10-   WT   NT   WTW   NTW   -S		8,5W	2700K	17°	500mA	1030 lm	86%
A333-0- ① -11-   WT   NT   WTW   NTW   -S		8,5W	3000K	17°	500mA	1070 lm	86%
A333-0- ① -12-   WT   NT   WTW   NTW   -S		8,5W	4000K	17°	500mA	1100 lm	86%
A333-0- ① -20-   WT   NT   WTW   NTW   -S		8,5W	2700K	24°	500mA	1030 lm	84%
A333-0- ① -21-   WT   NT   WTW   NTW   -S		8,5W	3000K	24°	500mA	1070 lm	84%
A333-0- ① -22-   WT   NT   WTW   NTW   -S		8,5W	4000K	24°	500mA	1100 lm	84%
A333-0- ① -30-   WT   NT   WTW   NTW   -S		8,5W	2700K	34°	500mA	1030 lm	89%
A333-0- ① -31-   WT   NT   WTW   NTW   -S		8,5W	3000K	34°	500mA	1070 lm	89%
A333-0- ① -32-   WT   NT   WTW   NTW   -S		8,5W	4000K	34°	500mA	1100 lm	89%

48 V | IP20 | CRI>90 | L80B10 >60.000h

MacAdam Step 3 | OPTIONS\* | INCL | TRACK 48V | 360° | 310° | 17° / 24° / 34°

OPTIONAL

SIX M High Chromatic LED	①	>> 536
SIX S High Chromatic LED	①	>> 536

NOT SOLD SEPARATELY  
AFFECT THE LIGHTING PARAMETERS

① \*OPTIONS

1	No DIM
2	DIM DALI

+RE REF. ENDING EXAMPLE

∅	Track 48V	A3300110WT
-S	Track 48V Short	A3300110WT-S

FINISHING	Lamp	Adaptor
WT	WT □   N ■	
NT	NT ■   N ■	
WTW	WT □   W □	
NTW	NT ■   W □	

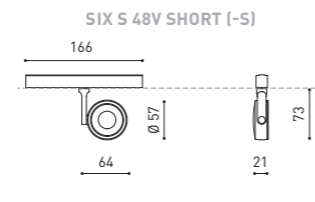
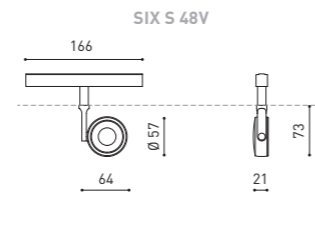
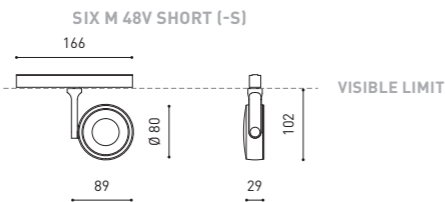
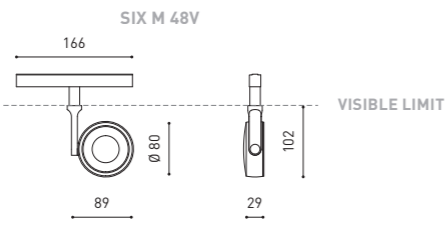

COLOUR | WT □ | NT ■ | W □ | N ■ | MATERIAL | AL | PC | RAL ① >> 538

+RE >> THE PRODUCTS FOR THE TRACK 48V SHORT, ADD "-S" AT THE END OF THE SALES REFERENCE (AFTER THE LETTERS WHICH INDICATE THE COLOUR OF THE PRODUCT). ((∞)) >> PLEASE CONSULT



>> MORE INFO

SIX XS 48V	+RE	P	CCT	Beam	I	Flux	LOR
A335-0- ① -10-   WT   NT   WTW   NTW   -S		4,5W	2700K	17°	500mA	470 lm	90%
A335-0- ① -11-   WT   NT   WTW   NTW   -S		4,5W	3000K	17°	500mA	500 lm	90%
A335-0- ① -12-   WT   NT   WTW   NTW   -S		4,5W	4000K	17°	500mA	530 lm	90%
A335-0- ① -20-   WT   NT   WTW   NTW   -S		4,5W	2700K	23°	500mA	470 lm	86%
A335-0- ① -21-   WT   NT   WTW   NTW   -S		4,5W	3000K	23°	500mA	500 lm	86%
A335-0- ① -22-   WT   NT   WTW   NTW   -S		4,5W	4000K	23°	500mA	530 lm	86%
A335-0- ① -30-   WT   NT   WTW   NTW   -S		4,5W	2700K	34°	500mA	470 lm	88%
A335-0- ① -31-   WT   NT   WTW   NTW   -S		4,5W	3000K	34°	500mA	500 lm	88%
A335-0- ① -32-   WT   NT   WTW   NTW   -S		4,5W	4000K	34°	500mA	530 lm	88%

48 V | IP20 | CRI>90 | L80B10 >60.000h

MacAdam Step 2 | OPTIONS\* | INCL | TRACK 48V | 360° | 310° | 17° / 23° / 34°



>> MORE INFO

SIX XS 48V Double	+RE	P	CCT	Beam	I	Flux	LOR
A335-1- ① -10-   WT   NT   WTW   NTW   -S		9W	2700K	17°	500mA	2 X 470 lm	90%
A335-1- ① -11-   WT   NT   WTW   NTW   -S		9W	3000K	17°	500mA	2 X 500 lm	90%
A335-1- ① -12-   WT   NT   WTW   NTW   -S		9W	4000K	17°	500mA	2 X 530 lm	90%
A335-1- ① -20-   WT   NT   WTW   NTW   -S		9W	2700K	23°	500mA	2 X 470 lm	86%
A335-1- ① -21-   WT   NT   WTW   NTW   -S		9W	3000K	23°	500mA	2 X 500 lm	86%
A335-1- ① -22-   WT   NT   WTW   NTW   -S		9W	4000K	23°	500mA	2 X 530 lm	86%
A335-1- ① -30-   WT   NT   WTW   NTW   -S		9W	2700K	34°	500mA	2 X 470 lm	88%
A335-1- ① -31-   WT   NT   WTW   NTW   -S		9W	3000K	34°	500mA	2 X 500 lm	88%
A335-1- ① -32-   WT   NT   WTW   NTW   -S		9W	4000K	34°	500mA	2 X 530 lm	88%

48 V | IP20 | CRI>90 | L80B10 >60.000h

MacAdam Step 2 | OPTIONS\* | INCL | TRACK 48V | 360° | 310° | 17° / 23° / 34°

OPTIONAL

SIX XS High Chromatic LED	①	>> 536
---------------------------	---	--------

NOT SOLD SEPARATELY  
AFFECTS THE LIGHTING PARAMETERS

① \*OPTIONS

1	No DIM
2	DIM DALI

+RE REF. ENDING EXAMPLE

∅	Track 48V	A3350110WT
-S	Track 48V Short	A3350110WT-S

FINISHING	Lamp	Adaptor
WT	WT □   N ■	
NT	NT ■   N ■	
WTW	WT □   W □	
NTW	NT ■   W □	

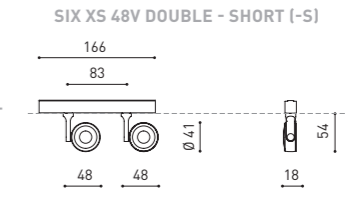
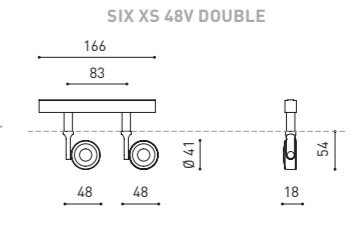
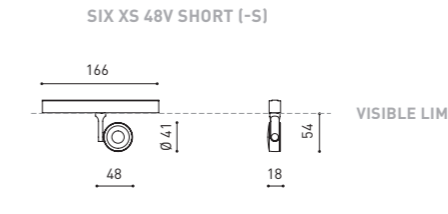
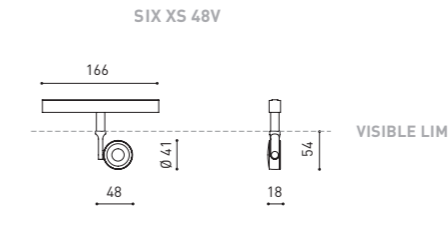

COLOUR | WT □ | NT ■ | W □ | N ■ | MATERIAL | AL | PC | RAL ① >> 538

+RE >> THE PRODUCTS FOR THE TRACK 48V SHORT, ADD "-S" AT THE END OF THE SALES REFERENCE (AFTER THE LETTERS WHICH INDICATE THE COLOUR OF THE PRODUCT). ((∞)) >> PLEASE CONSULT





48V SYSTEM  
FIT 48V



>> MORE INFO

FIT50 48V	+RE	P	CCT	Beam	I	Flux	LOR
A346-0-00-10-   WT   NT   G   WTW   NTW   GW   -S		12W	2700K	15°	1050mA	1040 lm	85%
A346-0-00-11-   WT   NT   G   WTW   NTW   GW   -S		12W	3000K	15°	1050mA	1120 lm	85%
A346-0-00-12-   WT   NT   G   WTW   NTW   GW   -S		12W	4000K	15°	1050mA	1230 lm	85%
A346-0-00-20-   WT   NT   G   WTW   NTW   GW   -S		12W	2700K	28°	1050mA	1040 lm	82%
A346-0-00-21-   WT   NT   G   WTW   NTW   GW   -S		12W	3000K	28°	1050mA	1120 lm	82%
A346-0-00-22-   WT   NT   G   WTW   NTW   GW   -S		12W	4000K	28°	1050mA	1230 lm	82%
A346-0-00-30-   WT   NT   G   WTW   NTW   GW   -S		12W	2700K	47°	1050mA	1040 lm	80%
A346-0-00-31-   WT   NT   G   WTW   NTW   GW   -S		12W	3000K	47°	1050mA	1120 lm	80%
A346-0-00-32-   WT   NT   G   WTW   NTW   GW   -S		12W	4000K	47°	1050mA	1230 lm	80%

48 V | III | IP20 | CRI>90 | L80B10 >60.000h



⊙	*OPTIONS
1	No DIM
2	DIM DALI

+RE	REF. ENDING	EXAMPLE
0	Track 48V	A3460110WT
-S	Track 48V Short	A3460110WT-S

FINISHING	Lamp	Adaptor
WT	WT □   N ■	
NT	NT ■   N ■	
G	G ■   N ■	
WTW	WT □   W □	
NTW	NT ■   W □	
GW	G ■   W □	

OPTIONAL ACCESSORY  
FIT 50 Anti-glare Honeycomb Louver \*\*  
A346-00-00



NOT SOLD SEPARATELY

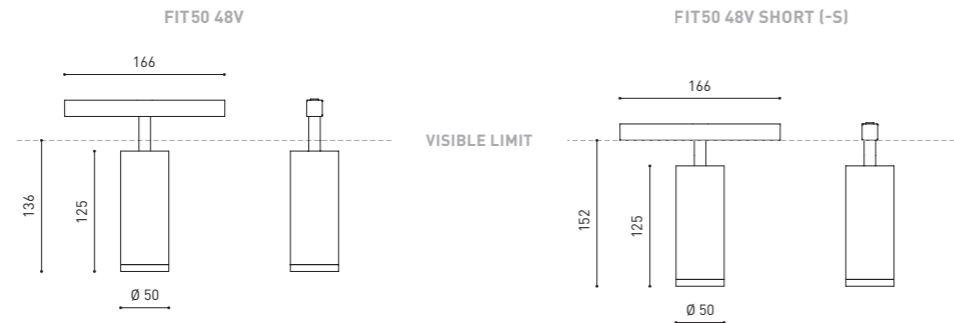

COLOUR | WT □ | NT ■ | G ■ | W □ | N ■ | MATERIAL | AL | PC | RAL ⓘ » 538

\*\* ACCESSORY AFFECTS THE LIGHTING PARAMETERS  
\*RE -> THE PRODUCTS FOR THE TRACK 48V SHORT, ADD "-S" AT THE END OF THE SALES REFERENCE (AFTER THE LETTERS WHICH INDICATE THE COLOUR OF THE PRODUCT). ⓘ » PLEASE CONSULT





>> MORE INFO

FIT 35 48V	+RE	P	CCT	Beam	I	Flux	LOR
A345-0- 00 -10-   WT   NT   G   WTW   NTW   GW   -S		5,5W	2700K	19°	500mA	590 lm	82%
A345-0- 00 -11-   WT   NT   G   WTW   NTW   GW   -S		5,5W	3000K	19°	500mA	630 lm	82%
A345-0- 00 -12-   WT   NT   G   WTW   NTW   GW   -S		5,5W	4000K	19°	500mA	700 lm	82%
A345-0- 00 -20-   WT   NT   G   WTW   NTW   GW   -S		5,5W	2700K	29°	500mA	590 lm	80%
A345-0- 00 -21-   WT   NT   G   WTW   NTW   GW   -S		5,5W	3000K	29°	500mA	630 lm	80%
A345-0- 00 -22-   WT   NT   G   WTW   NTW   GW   -S		5,5W	4000K	29°	500mA	700 lm	80%
A345-0- 00 -30-   WT   NT   G   WTW   NTW   GW   -S		5,5W	2700K	38°	500mA	590 lm	80%
A345-0- 00 -31-   WT   NT   G   WTW   NTW   GW   -S		5,5W	3000K	38°	500mA	630 lm	80%
A345-0- 00 -32-   WT   NT   G   WTW   NTW   GW   -S		5,5W	4000K	38°	500mA	700 lm	80%

48V | III | IP20 | CRI>90 | L80B10 >60.000h



00	*OPTIONS
1	No DIM
2	DIM DALI

+RE	REF. ENDING	EXAMPLE
0	Track 48V	A3450110WT
-S	Track 48V Short	A3450110WT-S

FINISHING	Lamp	Adaptor
WT	WT □   N ■	
NT	NT ■   N ■	
G	G ■   N ■	
WTW	WT □   W □	
NTW	NT ■   W □	
GW	G ■   W □	

OPTIONAL ACCESSORY  
 FIT 35 Anti-glare Honeycomb Louver \*\*  
 A345-00-00

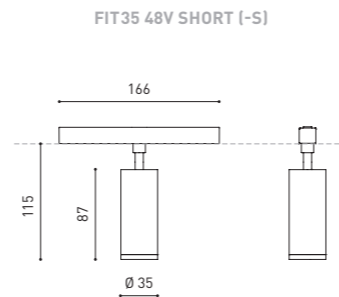
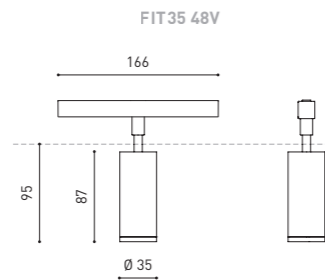

COLOUR | WT □ | NT ■ | G ■ | W □ | N ■ | MATERIAL | AL | PC | RAL ⓘ » 538

\*\* ACCESSORY AFFECTS THE LIGHTING PARAMETERS  
 \*RE -> THE PRODUCTS FOR THE TRACK 48V SHORT, ADD "-S" AT THE END OF THE SALES REFERENCE (AFTER THE LETTERS WHICH INDICATE THE COLOUR OF THE PRODUCT).  
 ⓘ » PLEASE CONSULT



>> MORE INFO

FIT 35 48V DOUBLE	+RE	P	CCT	Beam	I	Flux	LOR
A345-1- 00 -10-   WT   NT   G   WTW   NTW   GW   -S		11W	2700K	19°	500mA	2 x 590 lm	82%
A345-1- 00 -11-   WT   NT   G   WTW   NTW   GW   -S		11W	3000K	19°	500mA	2 x 630 lm	82%
A345-1- 00 -12-   WT   NT   G   WTW   NTW   GW   -S		11W	4000K	19°	500mA	2 x 700 lm	82%
A345-1- 00 -20-   WT   NT   G   WTW   NTW   GW   -S		11W	2700K	29°	500mA	2 x 590 lm	80%
A345-1- 00 -21-   WT   NT   G   WTW   NTW   GW   -S		11W	3000K	29°	500mA	2 x 630 lm	80%
A345-1- 00 -22-   WT   NT   G   WTW   NTW   GW   -S		11W	4000K	29°	500mA	2 x 700 lm	80%
A345-1- 00 -30-   WT   NT   G   WTW   NTW   GW   -S		11W	2700K	38°	500mA	2 x 590 lm	80%
A345-1- 00 -31-   WT   NT   G   WTW   NTW   GW   -S		11W	3000K	38°	500mA	2 x 630 lm	80%
A345-1- 00 -32-   WT   NT   G   WTW   NTW   GW   -S		11W	4000K	38°	500mA	2 x 700 lm	80%

48V | III | IP20 | CRI>90 | L80B10 >60.000h



00	*OPTIONS
1	No DIM
2	DIM DALI

+RE	REF. ENDING	EXAMPLE
0	Track 48V	A3451110WT
-S	Track 48V Short	A3451110WT-S

FINISHING	Lamp	Adaptor
WT	WT □   N ■	
NT	NT ■   N ■	
G	G ■   N ■	
WTW	WT □   W □	
NTW	NT ■   W □	
GW	G ■   W □	

OPTIONAL ACCESSORY  
 FIT 35 Anti-glare Honeycomb Louver \*\*  
 A345-00-00

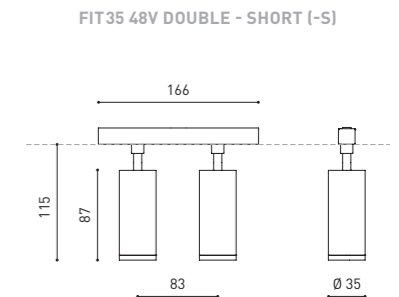
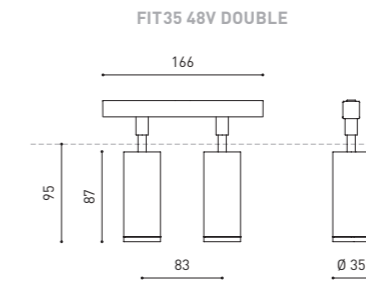

COLOUR | WT □ | NT ■ | G ■ | W □ | N ■ | MATERIAL | AL | PC | RAL ⓘ » 538

\*\* ACCESSORY AFFECTS THE LIGHTING PARAMETERS  
 \*RE -> THE PRODUCTS FOR THE TRACK 48V SHORT, ADD "-S" AT THE END OF THE SALES REFERENCE (AFTER THE LETTERS WHICH INDICATE THE COLOUR OF THE PRODUCT).  
 ⓘ » PLEASE CONSULT



Sub Zero & Wolf Sydney Showroom, Sydney, Australia | Adele Bates | Koda Lighting | ODK Stone | Photography: Fiona Susanto



Bulthaup Sant Cugat, Barcelona (Spain) | Francesc Rifé Studio | Photography: Montse Capdevila



>> MORE INFO



>> MORE INFO

FIT20 48V	+RE	P	CCT	Beam	I	Flux	LOR
A344-0-Ⓞ-10-   WT   NT   G   WTW   NTW   GW   -S		2,1W	2700K	12°	700mA	127 lm	87%
A344-0-Ⓞ-11-   WT   NT   G   WTW   NTW   GW   -S		2,1W	3000K	12°	700mA	150 lm	87%
A344-0-Ⓞ-20-   WT   NT   G   WTW   NTW   GW   -S		2,1W	2700K	30°	700mA	127 lm	88%
A344-0-Ⓞ-21-   WT   NT   G   WTW   NTW   GW   -S		2,1W	3000K	30°	700mA	150 lm	88%
A344-0-Ⓞ-30-   WT   NT   G   WTW   NTW   GW   -S		2,1W	2700K	54°	700mA	127 lm	81%
A344-0-Ⓞ-31-   WT   NT   G   WTW   NTW   GW   -S		2,1W	3000K	54°	700mA	150 lm	81%

48 V | III | IP20 | CRI>90 | L80B10 >50.000h



FIT20 48V DOUBLE	+RE	P	CCT	Beam	I	Flux	LOR
A344-1-Ⓞ-10-   WT   NT   G   WTW   NTW   GW   -S		4,2W	2700K	12°	700mA	2 x 127 lm	87%
A344-1-Ⓞ-11-   WT   NT   G   WTW   NTW   GW   -S		4,2W	3000K	12°	700mA	2 x 150 lm	87%
A344-1-Ⓞ-20-   WT   NT   G   WTW   NTW   GW   -S		4,2W	2700K	30°	700mA	2 x 127 lm	88%
A344-1-Ⓞ-21-   WT   NT   G   WTW   NTW   GW   -S		4,2W	3000K	30°	700mA	2 x 150 lm	88%
A344-1-Ⓞ-30-   WT   NT   G   WTW   NTW   GW   -S		4,2W	2700K	54°	700mA	2 x 127 lm	81%
A344-1-Ⓞ-31-   WT   NT   G   WTW   NTW   GW   -S		4,2W	3000K	54°	700mA	2 x 150 lm	81%

48 V | III | IP20 | CRI>90 | L80B10 >50.000h



Ⓞ	*OPTIONS
1	No DIM
2	DIM DALI

+RE	REF. ENDING	EXAMPLE
Ⓞ	Track 48V	A3440110WT
-S	Track 48V Short	A3440110WT-S

FINISHING	Lamp	Adaptor
WT	WT □   N ■	
NT	NT ■   N ■	
G	G ■   N ■	
WTW	WT □   W □	
NTW	NT ■   W □	
GW	G ■   W □	

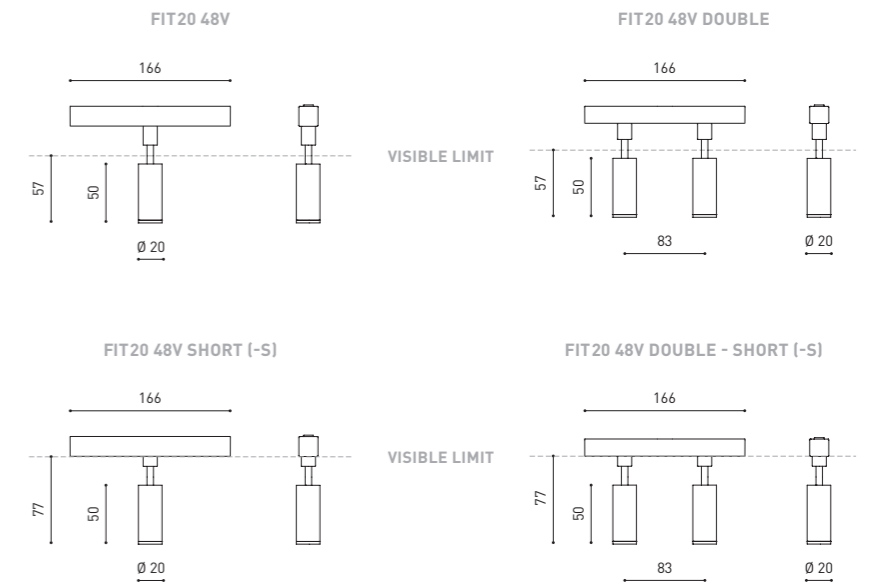

COLOUR | WT □ | NT ■ | G ■ | W □ | N ■ | MATERIAL | AL | PC | RAL ⓘ » 538

+RE >> THE PRODUCTS FOR THE TRACK 48V SHORT, ADD "-S" AT THE END OF THE SALES REFERENCE (AFTER THE LETTERS WHICH INDICATE THE COLOUR OF THE PRODUCT).

Ⓞ ⓘ » PLEASE CONSULT



Photography: Jesús Granada

## 48V SYSTEM PLUS 48V



>> MORE INFO



>> MORE INFO

### OPTIONAL

PLUS High Chromatic LED ⓘ » 536

PLUS MINI High Chromatic LED ⓘ » 536

NOT SOLD SEPARATELY  
AFFECT THE LIGHTING PARAMETERS

FINISHING	Lamp	Adaptor
WT	WT □   N ■	
NT	NT ■   N ■	
WTW	WT □   W □	
NTW	NT ■   W □	

PLUS 48V	+RE	P	CCT	Beam	I	Flux	LOR
A323-00- ① -0-   WT   NT   WTW   NTW   -S		18W	2700K	12°-51°	500mA	1920 lm	26-40%
A323-00- ① -1-   WT   NT   WTW   NTW   -S		18W	3000K	12°-51°	500mA	2000 lm	26-40%
A323-00- ① -2-   WT   NT   WTW   NTW   -S		18W	4000K	12°-51°	500mA	2030 lm	26-40%

48 V | ⓘ IP20 | CRI>90 | L80B10 > 60.000h



PLUS Mini 48V	+RE	P	CCT	Beam	I	Flux	LOR
A326-00- ① -0-   WT   NT   WTW   NTW   -S		6,5W	2700K	10°-41°	700mA	630 lm	20-40%
A326-00- ① -1-   WT   NT   WTW   NTW   -S		6,5W	3000K	10°-41°	700mA	660 lm	20-40%
A326-00- ① -2-   WT   NT   WTW   NTW   -S		6,5W	4000K	10°-41°	700mA	680 lm	20-40%

48 V | ⓘ IP20 | CRI>90 | L80B10 > 60.000h

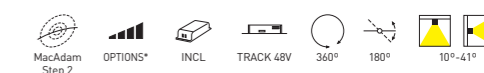

### ① \*OPTIONS

1	No DIM
2	DIM DALI

### +RE REF. ENDING EXAMPLE

∅	Track 48V	A3230010WT
-S	Track 48V Short	A3230010WT-S

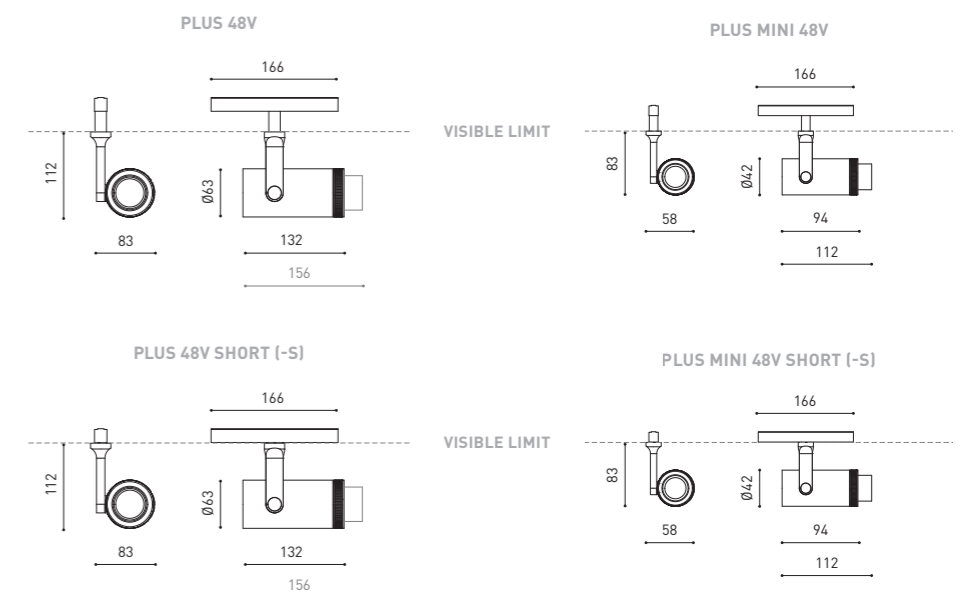

COLOUR | WT □ | NT ■ | W □ | N ■ | MATERIAL | AL | OPTICAL GLASS || OPTICAL PMMA | RAL ⓘ » 536

+RE >> THE PRODUCTS FOR THE TRACK 48V SHORT, ADD "-S" AT THE END OF THE SALES REFERENCE (AFTER THE LETTERS WHICH INDICATE THE COLOUR OF THE PRODUCT).

ⓘ » PLEASE CONSULT

48V SYSTEM  
iO 48V



>> MORE INFO

FINISHING	Lamp	Adaptor
WT	WT <input type="checkbox"/>   N <input type="checkbox"/>	
NT	NT <input type="checkbox"/>   N <input type="checkbox"/>	
WTW	WT <input type="checkbox"/>   W <input type="checkbox"/>	
NTW	NT <input type="checkbox"/>   W <input type="checkbox"/>	

iO 48V	+RE	P	CCT	Beam	I	Flux	LOR
A348-0- <input type="checkbox"/> -10-   WT   NT   WTW   NTW   -S		4,5W	2700K	20°	500mA	485 lm	92%
A348-0- <input type="checkbox"/> -11-   WT   NT   WTW   NTW   -S		4,5W	3000K	20°	500mA	505 lm	92%
A348-0- <input type="checkbox"/> -20-   WT   NT   WTW   NTW   -S		4,5W	2700K	30°	500mA	485 lm	89%
A348-0- <input type="checkbox"/> -21-   WT   NT   WTW   NTW   -S		4,5W	3000K	30°	500mA	505 lm	89%
A348-0- <input type="checkbox"/> -30-   WT   NT   WTW   NTW   -S		4,5W	2700K	56°	500mA	485 lm	86%
A348-0- <input type="checkbox"/> -31-   WT   NT   WTW   NTW   -S		4,5W	3000K	56°	500mA	505 lm	86%

48 V | IP20 | CRI>90 | L80B10 > 60.000h



<input type="checkbox"/>	*OPTIONS
1	No DIM
2	DIM DALI

+RE	REF. ENDING	EXAMPLE
<input type="checkbox"/>	Track 48V	A3480110WT
-S	Track 48V Short	A3480110WT-S

OPTIONAL ACCESSORIES

NOT SOLD SEPARATELY

iO Beam Mixer Diffuser\*\* 0805-01-00



iO Anti-glare Honeycomb Louver\*\* 0806-00-00 | WT | NT |



iO High Chromatic LED\*\* » 536

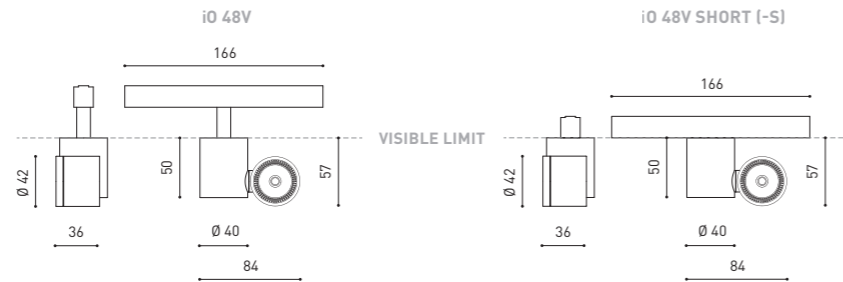

COLOUR | WT  | NT  | W  | N  |

MATERIAL | AL | PC |

RAL » 538

\*\* AFFECTS THE LIGHTING PARAMETERS

\*RE -> THE PRODUCTS FOR THE TRACK 48V SHORT, ADD "-S" AT THE END OF THE SALES REFERENCE (AFTER THE LETTERS WHICH INDICATE THE COLOUR OF THE PRODUCT).

» PLEASE CONSULT



# 48V SYSTEM ZEN TUBE 48V



>> MORE INFO

		+RE	P	CCT	I	Flux	LOR
ZEN TUBE 48V 1	A341-11- 00 -0-   WT   NT   WTW   NTW   -S	12W	2700K	350mA	1580 lm	90%	
	A341-11- 00 -1-   WT   NT   WTW   NTW   -S	12W	3000K	350mA	1640 lm	90%	
ZEN TUBE 48V 2	A341-12- 00 -0-   WT   NT   WTW   NTW   -S	17W	2700K	500mA	2130 lm	90%	
	A341-12- 00 -1-   WT   NT   WTW   NTW   -S	17W	3000K	500mA	2220 lm	90%	
ZEN TUBE 48V 3	A341-13- 00 -0-   WT   NT   WTW   NTW   -S	23W	2700K	700mA	3070 lm	90%	
	A341-13- 00 -1-   WT   NT   WTW   NTW   -S	23W	3000K	700mA	3190 lm	90%	
DALI	A341-23- 00 -0-   WT   NT   WTW   NTW   -S	23W	2700K	700mA	3070 lm	90%	
	A341-23- 00 -1-   WT   NT   WTW   NTW   -S	23W	3000K	700mA	3190 lm	90%	

48V | IP20 | CRI>90 | L80B10 >60,000h

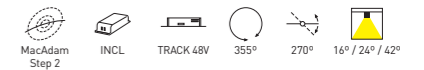

### 00 BEAM OPTIONS

1	16°
2	24°
3	42°

+RE	REF. ENDING	EXAMPLE
0	Track 48V	A3411110WT
-S	Track 48V Short	A3411110WT-S

FINISHING	Lamp	Adaptor
WT	WT □	N ■
NT	NT ■	N ■
WTW	WT □	W □
NTW	NT ■	W □

### ZEN TUBE 48V

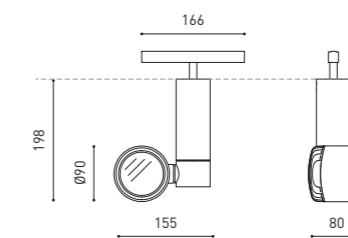

### ZEN TUBE 48V SHORT (-S)

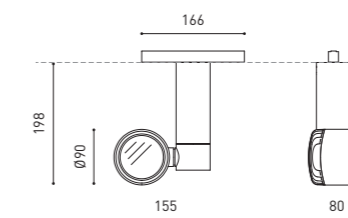

### OPTIONAL ACCESSORIES

NOT SOLD SEPARATELY

ZEN Anti-glare Honeycomb Louver\* 0702-02-00



ZEN Elliptical Refractor\* 0700-08-00



ZEN Beam Mixer Diffuser\* 0805-02-00



ZEN High Chromatic LED\*

COLOUR | WT □ | NT ■ | W □ | N ■ |

MATERIAL | AL | GL-TRANS |

RAL ⓘ » 538

\* AFFECTS THE LIGHTING PARAMETERS

ⓘ » PLEASE CONSULT

+RE >> THE PRODUCTS FOR THE TRACK 48V SHORT, ADD "-S" AT THE END OF THE SALES REFERENCE (AFTER THE LETTERS WHICH INDICATE THE COLOUR OF THE PRODUCT).

48V SYSTEM  
TOP 48V



>> MORE INFO

TOP 48V	+RE	P	CCT	Beam	I	Flux	LOR
A339-0- Ⓞ -10-   WT   NT   WTW   NTW   -S		6,5W	2700K	20°	700mA	610 lm	92%
A339-0- Ⓞ -11-   WT   NT   WTW   NTW   -S		6,5W	3000K	20°	700mA	640 lm	92%
A339-0- Ⓞ -20-   WT   NT   WTW   NTW   -S		6,5W	2700K	30°	700mA	610 lm	89%
A339-0- Ⓞ -21-   WT   NT   WTW   NTW   -S		6,5W	3000K	30°	700mA	640 lm	89%
A339-0- Ⓞ -30-   WT   NT   WTW   NTW   -S		6,5W	2700K	56°	700mA	610 lm	86%
A339-0- Ⓞ -31-   WT   NT   WTW   NTW   -S		6,5W	3000K	56°	700mA	640 lm	86%

48V Ⓞ IP20 | CRI>90 | L80B10 >60.000h



FINISHING	Lamp	Adaptor
WT	WT □   N ■	
NT	NT ■   N ■	
WTW	WT □   W □	
NTW	NT ■   W □	

Ⓞ	*OPTIONS
1	No DIM
2	DIM DALI

+RE	REF. ENDING	EXAMPLE
⌀	Track 48V	A3390110WT
-S	Track 48V Short	A3390110WT-S

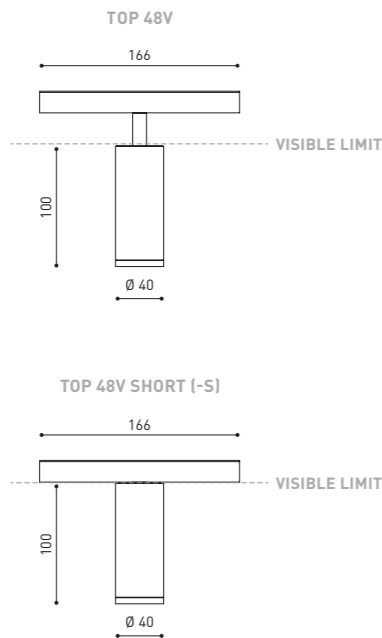

OPTIONAL ACCESSORIES  
NOT SOLD SEPARATELY

TOP Beam Mixer Diffuser\*\* 0805-01-00



TOP Anti-glare Honeycomb Louver\*\* 0807-00-00 | WT | NT |



TOP High Chromatic LED\*\* ⓘ » 536

COLOUR | WT □ | NT ■ | W □ | N ■ | MATERIAL | AL | PC | RAL ⓘ » 538

\*\* AFFECTS THE LIGHTING PARAMETERS  
\*RE >> THE PRODUCTS FOR THE TRACK 48V SHORT, ADD "-S" AT THE END OF THE SALES REFERENCE (AFTER THE LETTERS WHICH INDICATE THE COLOUR OF THE PRODUCT). ⓘ » PLEASE CONSULT



>> MORE INFO

TOP Mini 48V	+RE	P	CCT	Beam	I	Flux	LOR
A340-0- Ⓞ -10-   WT   NT   WTW   NTW   -S		6,5W	2700K	20°	700mA	610 lm	92%
A340-0- Ⓞ -11-   WT   NT   WTW   NTW   -S		6,5W	3000K	20°	700mA	640 lm	92%
A340-0- Ⓞ -20-   WT   NT   WTW   NTW   -S		6,5W	2700K	30°	700mA	610 lm	89%
A340-0- Ⓞ -21-   WT   NT   WTW   NTW   -S		6,5W	3000K	30°	700mA	640 lm	89%
A340-0- Ⓞ -30-   WT   NT   WTW   NTW   -S		6,5W	2700K	56°	700mA	610 lm	86%
A340-0- Ⓞ -31-   WT   NT   WTW   NTW   -S		6,5W	3000K	56°	700mA	640 lm	86%

48V Ⓞ IP20 | CRI>90 | L80B10 >60.000h



FINISHING	Lamp	Adaptor
WT	WT □   N ■	
NT	NT ■   N ■	
WTW	WT □   W □	
NTW	NT ■   W □	

Ⓞ	*OPTIONS
1	No DIM
2	DIM DALI

+RE	REF. ENDING	EXAMPLE
⌀	Track 48V	A3400110WT
-S	Track 48V Short	A3400110WT-S

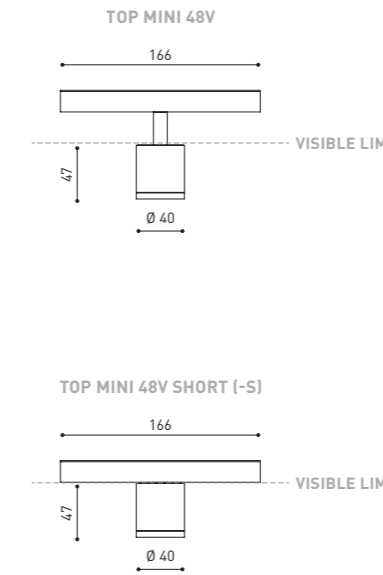

OPTIONAL ACCESSORIES  
NOT SOLD SEPARATELY

TOP Beam Mixer Diffuser\*\* 0805-01-00



TOP Anti-glare Honeycomb Louver\*\* 0807-00-00 | WT | NT |



TOP High Chromatic LED\*\* ⓘ » 536

COLOUR | WT □ | NT ■ | W □ | N ■ | MATERIAL | AL | PC | RAL ⓘ » 538

\*\* AFFECTS THE LIGHTING PARAMETERS  
\*RE >> THE PRODUCTS FOR THE TRACK 48V SHORT, ADD "-S" AT THE END OF THE SALES REFERENCE (AFTER THE LETTERS WHICH INDICATE THE COLOUR OF THE PRODUCT). ⓘ » PLEASE CONSULT





## 48V SYSTEM LINE 48V



>> MORE INFO

		P	CCT	I	Flux	LOR
LINE 500 48V	A376-10- ② -0-   N   W**	10,5W	2700K	350mA	1500 lm	43%
	A376-10- ② -1-   N   W**	10,5W	3000K	350mA	1600 lm	43%
	A376-10- ② -2-   N   W**	10,5W	4000K	350mA	1650 lm	43%
LINE 1000 48V	A376-20- ② -0-   N   W**	21W	2700K	700mA	3000 lm	43%
	A376-20- ② -1-   N   W**	21W	3000K	700mA	3200 lm	43%
	A376-20- ② -2-   N   W**	21W	4000K	700mA	3300 lm	43%
LINE 2000 48V	A376-30- ② -0-   N   W**	42W	2700K	700mA	6000 lm	43%
	A376-30- ② -1-   N   W**	42W	3000K	700mA	6400 lm	43%
	A376-30- ② -2-   N   W**	42W	4000K	700mA	6600 lm	43%

48V | III IP20 | CRI>90 | L80B10 >60.000h



### ② \*OPTIONS

1	No DIM
2	DIM DALI

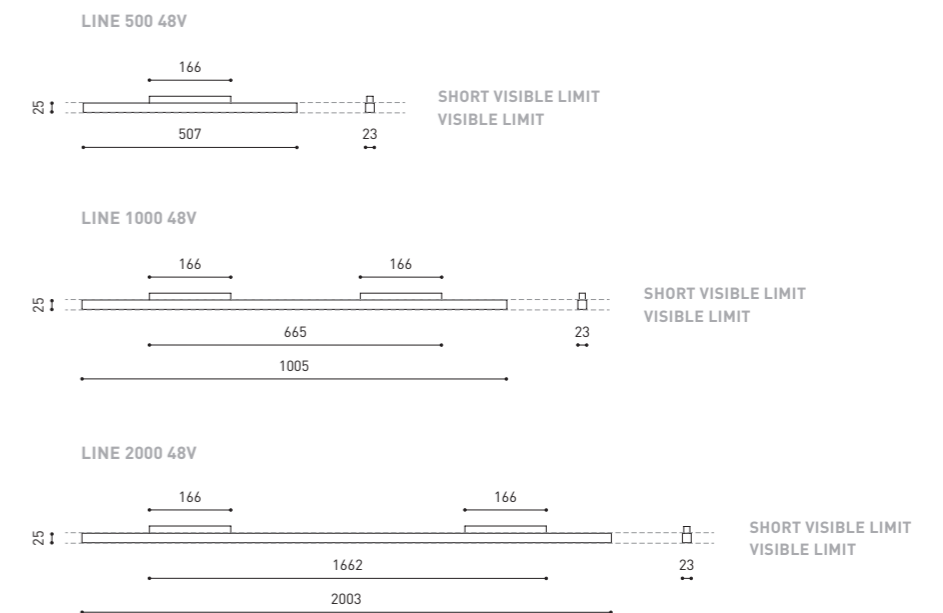

COLOUR | N ■ | W □ | MATERIAL | AL | PC |

RAL ⓘ » 538

\*\* NOT SUGGESTED FOR TRACK 48V SHORT

ⓘ » PLEASE CONSULT

48V SYSTEM

BLACK FOSTER MICRO 48V



>> MORE INFO



>> MORE INFO

		P	CCT	I	Flux	LOR
BLACK FOSTER Micro 48V 5	A416-20- 0-0-   N	7W	2700K	500mA	775 lm	87%
	A416-20- 0-1-   N	7W	3000K	500mA	800 lm	87%
	A416-20- 0-2-   N	7W	4000K	500mA	850 lm	87%

48 V | III IP20 | CRI>90 | L90B10 >60.000h



		P	CCT	I	Flux	LOR
BLACK FOSTER Micro 48V 10	A416-50- 0-0-   N	14W	2700K	500mA	1550 lm	87%
	A416-50- 0-1-   N	14W	3000K	500mA	1600 lm	87%
	A416-50- 0-2-   N	14W	4000K	500mA	1700 lm	87%

48 V | III IP20 | CRI>90 | L90B10 >60.000h



Ⓞ OPTIONS\*

1	No DIM
2	DIM DALI

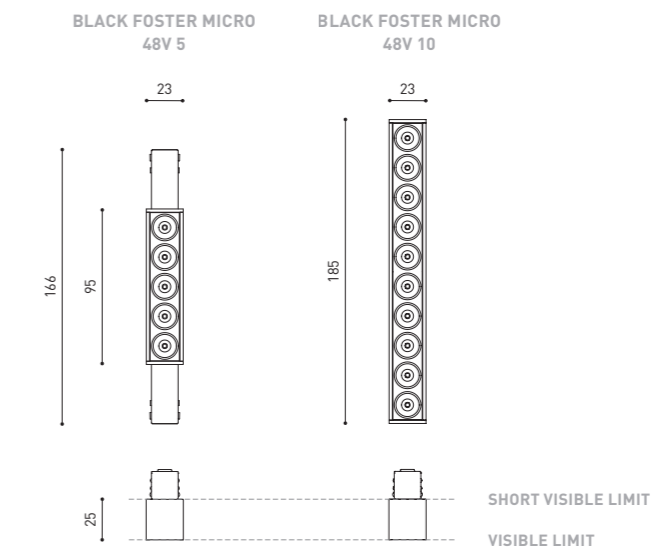

COLOUR | N ■ | MATERIAL | AL | ABS+PC |

RAL ⓘ » 538

Ⓞ » PLEASE CONSULT

48V SYSTEM  
STICK 48V



>> MORE INFO

STICK 48V	P	CCT	Beam	I	Flux	LOR
A40-○-⊙-⊙-10-   WT   NT   MG   WTW   NTW   MGW	5,6W	2700K	22°	500mA	530 lm	84%
A40-○-⊙-⊙-11-   WT   NT   MG   WTW   NTW   MGW	5,6W	3000K	22°	500mA	600 lm	84%
A40-○-⊙-⊙-20-   WT   NT   MG   WTW   NTW   MGW	5,6W	2700K	37°	500mA	530 lm	82%
A40-○-⊙-⊙-21-   WT   NT   MG   WTW   NTW   MGW	5,6W	3000K	37°	500mA	600 lm	82%
A40-○-⊙-⊙-30-   WT   NT   MG   WTW   NTW   MGW	5,6W	2700K	46°	500mA	530 lm	81%
A40-○-⊙-⊙-31-   WT   NT   MG   WTW   NTW   MGW	5,6W	3000K	46°	500mA	600 lm	81%

48 V | III | IP20 | CRI>90 | L80B10 > 60.000 h



○ STICK LENGTH	⊙ CORD LENGTH-L	⊙ OPTIONS*
7 STICK 22 220 mm	0 2 m	1 No DIM
8 STICK 44 440 mm	2 5 m	2 DIM DALI
9 STICK 66 660 mm		

OPTIONAL ACCESSORY

CORD Accessory

0223-00-00- | N |

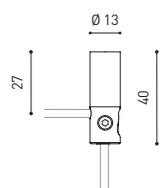

FINISHING	Lamp	Adaptor
WT	WT □   N ■	
NT	NT ■   N ■	
MG	MG ■   N ■	
WTW	WT □   W □	
NTW	NT ■   W □	
MGW	MG ■   W □	

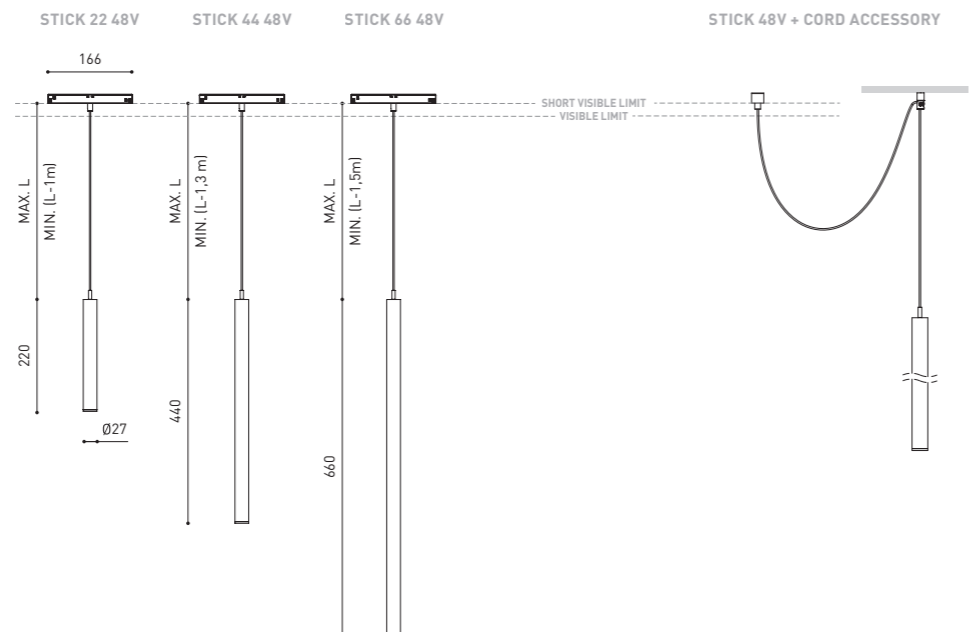

COLOUR | WT □ | NT ■ | MG ■ | W □ | N ■ |

MATERIAL | AL | ABS+PC |

RAL ⓘ » 538

ⓘ » PLEASE CONSULT





Arkostight Stand, EuroLuce 2019, Milano (Italy) | Francesz Rifé Studio | Photography: Alfonso Calza

## 48V SYSTEM HOLLY 48V



>> MORE INFO

HOLLY 48V										P	CCT	Beam	I	Flux	LOR											
A349-	⊘	-1-00-		WT		NT		MC		MG		WTW		NTW		MCW		MGW		2,1W	2700K	19°	700mA	190 lm	90%	
A349-	⊘	-1-01-		WT		NT		MC		MG		WTW		NTW		MCW		MGW		2,1W	3000K	19°	700mA	210 lm	90%	
A349-	⊘	-1-10-		WT		NT		MC		MG		WTW		NTW		MCW		MGW		2,1W	2700K	38°	700mA	190 lm	92%	
A349-	⊘	-1-11-		WT		NT		MC		MG		WTW		NTW		MCW		MGW		2,1W	3000K	38°	700mA	210 lm	92%	
A349-	⊘	-2-00-		WT		NT		MC		MG		WTW		NTW		MCW		MGW		2,1W	2700K	19°	700mA	190 lm	90%	
A349-	⊘	-2-01-		WT		NT		MC		MG		WTW		NTW		MCW		MGW		2,1W	3000K	19°	700mA	210 lm	90%	
A349-	⊘	-2-10-		WT		NT		MC		MG		WTW		NTW		MCW		MGW		2,1W	2700K	38°	700mA	190 lm	92%	
DALI	A349-	⊘	-2-11-		WT		NT		MC		MG		WTW		NTW		MCW		MGW		2,1W	3000K	38°	700mA	210 lm	92%

48 V | IP20 | CRI>90 | L80B10 > 60.000h



⊘	SUSPENSION DISTANCE
0	2 m
1	3 m
2	5 m

ADJUSTMENT RANGE 2m

### OPTIONAL ACCESSORY

#### CORD Accessory

0223-00-00- | W | N |

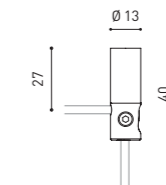

FINISHING	Lamp	Adaptor	Cord
WT	WT <input type="checkbox"/>	N <input type="checkbox"/>	W <input type="checkbox"/>
NT	NT <input type="checkbox"/>	N <input type="checkbox"/>	N <input type="checkbox"/>
MC	MC <input type="checkbox"/>	N <input type="checkbox"/>	N <input type="checkbox"/>
MG	MG <input type="checkbox"/>	N <input type="checkbox"/>	N <input type="checkbox"/>
WTW	WT <input type="checkbox"/>	W <input type="checkbox"/>	W <input type="checkbox"/>
NTW	NT <input type="checkbox"/>	W <input type="checkbox"/>	N <input type="checkbox"/>
MCW	MC <input type="checkbox"/>	W <input type="checkbox"/>	W <input type="checkbox"/>
MGW	MG <input type="checkbox"/>	W <input type="checkbox"/>	W <input type="checkbox"/>

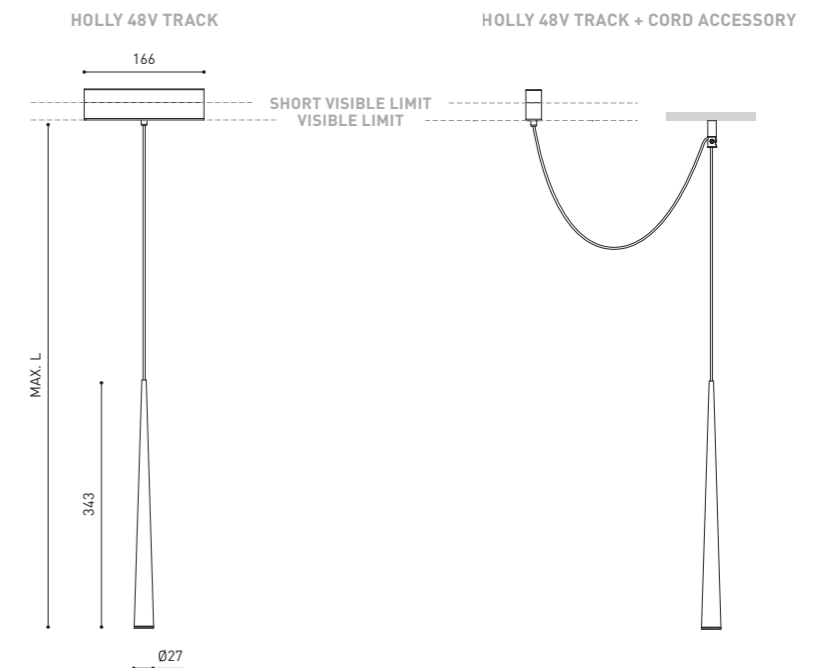

COLOUR | WT  | NT  | MC  | MG  | W  | N  | MATERIAL | AL | ABS | RAL » 538

» PLEASE CONSULT



## 48V SYSTEM SPIN 48V



>> MORE INFO

SPIN 48V	P	CCT	Beam	I	Flux	LOR
A350-⊙-1-00-   WT   NT   MC   MG   WTW   NTW   MCW   MGW	6,5W	2700K	24°	700mA	600 lm	86%
A350-⊙-1-01-   WT   NT   MC   MG   WTW   NTW   MCW   MGW	6,5W	3000K	24°	700mA	630 lm	86%
A350-⊙-1-10-   WT   NT   MC   MG   WTW   NTW   MCW   MGW	6,5W	2700K	40°	700mA	600 lm	84%
A350-⊙-1-11-   WT   NT   MC   MG   WTW   NTW   MCW   MGW	6,5W	3000K	40°	700mA	630 lm	84%
A350-⊙-2-00-   WT   NT   MC   MG   WTW   NTW   MCW   MGW	6,5W	2700K	24°	700mA	600 lm	86%
A350-⊙-2-01-   WT   NT   MC   MG   WTW   NTW   MCW   MGW	6,5W	3000K	24°	700mA	630 lm	86%
A350-⊙-2-10-   WT   NT   MC   MG   WTW   NTW   MCW   MGW	6,5W	2700K	40°	700mA	600 lm	84%
DALI A350-⊙-2-11-   WT   NT   MC   MG   WTW   NTW   MCW   MGW	6,5W	3000K	40°	700mA	630 lm	84%

48 V | IP20 | CRI>90 | L80B10 >60.000h



⊙	SUSPENSION DISTANCE
0	2 m
1	3 m
2	5 m

ADJUSTMENT RANGE 2m

### OPTIONAL ACCESSORY

#### CORD Accessory

0223-00-00- | W | N |

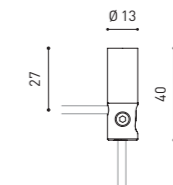

FINISHING	Lamp	Adaptor	Cord
WT	WT □   N ■	W □	N ■
NT	NT ■   N ■	N ■	W □
MC	MC ■   N ■	N ■	N ■
MG	MG ■   N ■	N ■	N ■
WTW	WT □   W □	W □	W □
NTW	NT ■   W □	N ■	W □
MCW	MC ■   W □	W □	W □
MGW	MG ■   W □	W □	W □

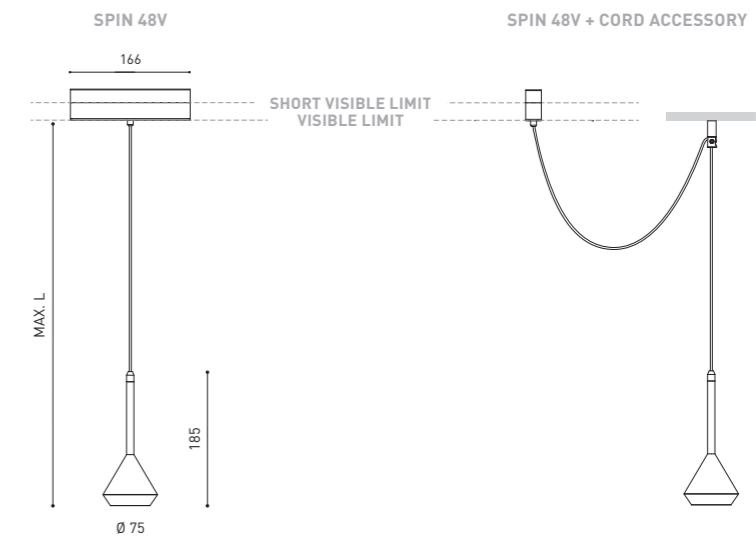

COLOUR | WT □ | NT ■ | MC ■ | MG ■ | W □ | N ■ | MATERIAL | AL | PMMA | RAL ⓘ » 538

» PLEASE CONSULT

# Track 48V

INDIRECT LIGHT

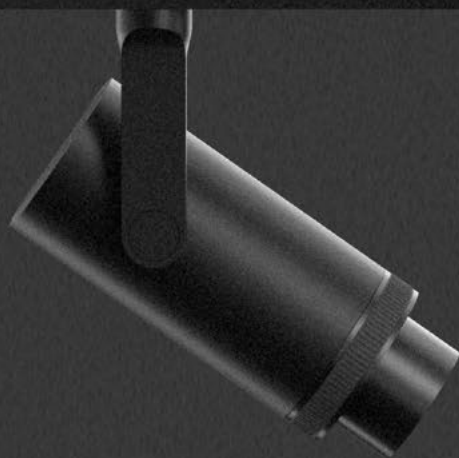



>> MORE INFO

		P	CCT	Flux	LOR	L
TRACK 48V + IND. LIGHT 1400	A466-01-20-   NT   WT	18,3W	2700K	2320lm	70%	1402mm
	A466-01-21-   WT   NT	18,3W	3000K	2380lm	70%	1402mm
	A466-01-22-   WT   NT	18,3W	4000K	2585lm	70%	1402mm
TRACK 48V + IND. LIGHT 2800	A466-02-20-   WT   NT	39,2W	2700K	5210lm	70%	2802mm
	A466-02-21-   WT   NT	39,2W	3000K	5360lm	70%	2802mm
	A466-02-22-   WT   NT	39,2W	4000K	5820lm	70%	2802mm

48 V | III | IP20 | CRI>90 | L90B5 >50.000h

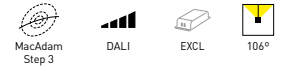

TRACK 48V + INDIRECT LIGHT  
1400 / 2800

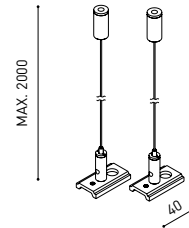
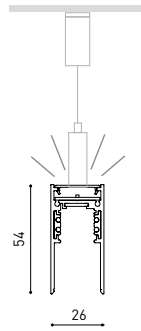

Indirect Light Suspension kit 48V (2 units)  
A466-00-03- | NT | WT |

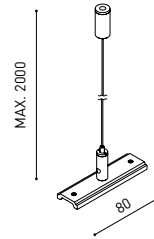

Suspension straight joiner kit 48V  
A466-00-04- | NT | WT |

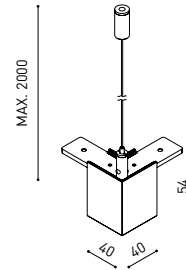

Suspension 90° Corner joiner kit 48V  
A466-00-05- | NT | WT |  
\*Electrical connection not included.

DROP VOLTAGE TABLE

POWER (W)	CABLE SECTION (mm <sup>2</sup> )	CABLE LENGTH (m)			
		5	10	20	30
100	0,75	50	50	X	X
	1,5	50	50	40	25
150	0,75	40	15	X	X
	1,5	50	40	20	X

For calculations, you must consider indirect light power.

	P	V	D (A x B x C)	
CONSTANT VOLTAGE	0434-01-61*   N	100W	48V	298 x 19 x 16mm
LED POWER SUPPLY	0434-01-62	150W	48V	350 x 30 x 18mm

220 V~ | \*To be installed inside the track.

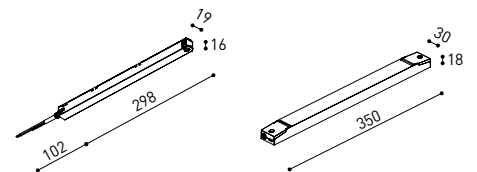

COLOUR | NT ■ | N ■ | WT □ | MATERIAL | AL | PC |

Ⓒ PLEASE CONSULT

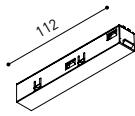

Live-End Connector 48V

A338-00-01- | N | W |

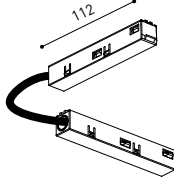

L-Joint Connector 48V

A338-00-12- | N | W |

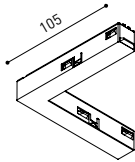

Corner 90° Connector One Plane 48V

A338-00-24- | N | W |



End 48V

A338-00-06- | NT | WT |

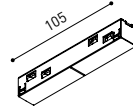

Central Connector 48V

A338-00-02- | N | W |

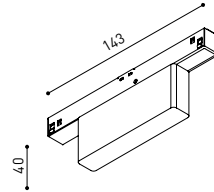

Wireless Control 48V

0434-01-31- | N | W | Casambi/AAG Stucchi App

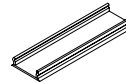

Cover Gap 1m 48V

A338-00-30- | N | W |



End Feed 48V

A338-00-07- | NT | WT |

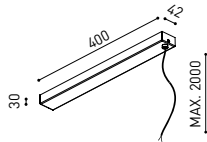

Wired Power Supply Case 48V

A338-00-25- | NT | WT | 150W NO DIM

A338-00-26- | NT | WT | 150W DIM

220 V~  
240 V~  
INCL

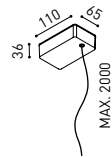

Suspension Feed Kit

A338-00-16- | N | W | NO DIM

A338-00-17- | N | W | DIM

For remote power supply

A338-00-27- | N | W | NO DIM

A338-00-28- | N | W | DIM

For power supply inside the track

MAINS TRIMLESS



MAINS THICK TRIMLESS



STEEL CABLE TRIMLESS

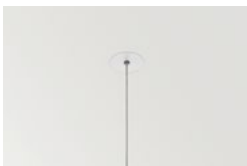

WIRE TRIMLESS ACCESSORIES

FEED

Mains Trimless\*

A023-00-01- | W | N | NO DIM

Mains Thick Trimless\*

A023-00-02- | W | N | DIM

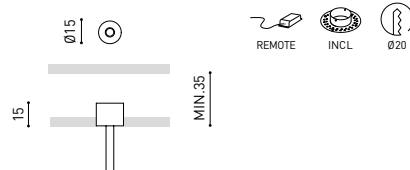

FASTENING

Steel Cable Trimless\*

A023-00-05- | W | N |

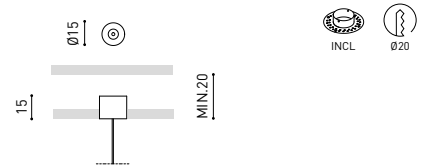

COLOUR | WT □ | NT ■ | W □ | N ■ |

MATERIAL | AL □ | PC □ |

\* AS MANY PIECES AS NEEDED ACCORDING TO YOUR PRODUCT

» PLEASE CONSULT





# lichtmacher

Wir bringen Licht

„ Dunkelheit existiert nicht, nur die Abwesenheit von Licht. “



Dies ist nur ein kleiner Ausschnitt aus unserem Gesamtsortiment.  
Fragen Sie uns an.